

## Specification AS1270(12V7AH/20Hr)

Nominal Voltage		12V
Rated Capacity (20 hour rate)		7.0AH
Dimension	Length	151±1mm (5.95in)
	Width	65±1mm (2.56in)
	Height	95±1mm (3.74in)
	Total Height (with terminals)	100±1mm (3.94in)
Weight		Approx 2.1kg ±2%(4.63lbs)

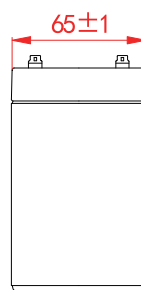

Unit:mm Dimension:151(L)×65(W)×95(H)

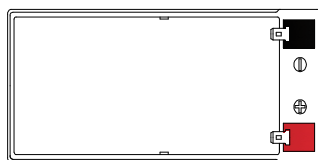
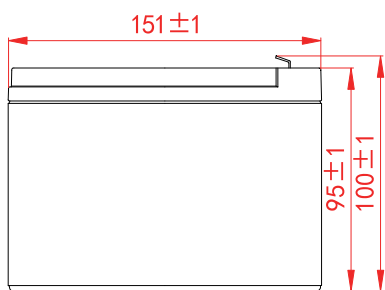

Terminal:T1

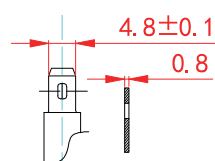

Terminal:T2

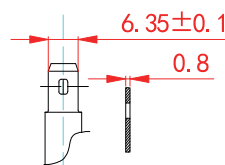

## Characteristic

Capacity 25°C(77°F)	20 hour rate (0.35A)	7.0AH
	5 hour rate (1.19A)	6.0AH
	1 hour rate (4.2A)	4.2AH
Internal Resistance	Full charged Battery 25°C(77°F)	25mΩ
Capacity affected by Temperature (10 hour rate)	40°C(104°F)	103%
	25°C(77°F)	100%
	0°C(32°F)	85%
	-15°C(5°F)	65%
Self-Discharge 25°C(77°F)	Capacity after 3 month storage	91%
	Capacity after 6 month storage	82%
	Capacity after 12 month storage	65%
Max. Discharge Current	140A (5S) 25°C(77°F)	
Terminal	Standard	T1
	Optional	T2
Charging (Constant Voltage)	Cycle	Initial Charging Current 2.1A or small 14.40~15.00V 25°C(77°F)
	Float	13.50~13.80V 25°C(77°F)

## Applications

- ☆ All purpose
- ☆ Uninterruptable Power Supply(UPS)
- ☆ Electric Power System(EPS)
- ☆ Emergency backup power supply
- ☆ Emergency light
- ☆ Railway signal
- ☆ Aircraft signal
- ☆ Alarm and security system
- ☆ Electronic apparatus and equipment
- ☆ Communication power supply
- ☆ DC power supply
- ☆ Auto control system

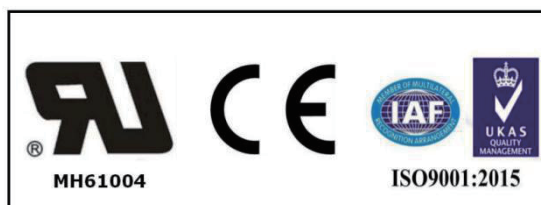

### Constant Current Discharge(Amperes) at 25°C(77°F)

F.V/Time	10min	15min	30min	1H	2H	3H	4H	5H	8H	10H	20H
1.85V/cell	13.0	10.1	6.11	3.67	2.26	1.66	1.34	1.14	0.770	0.634	0.334
1.80V/cell	14.5	11.1	6.59	3.91	2.37	1.74	1.39	1.18	0.797	0.653	0.342
1.75V/cell	15.6	11.8	6.97	4.10	2.46	1.80	1.44	1.22	0.821	0.669	0.350
1.70V/cell	16.5	12.4	7.26	4.24	2.53	1.84	1.47	1.24	0.832	0.681	0.354
1.65V/cell	17.2	12.9	7.48	4.35	2.58	1.88	1.50	1.26	0.844	0.688	0.358
1.60V/cell	17.7	13.2	7.65	4.43	2.62	1.90	1.51	1.28	0.856	0.696	0.362

### Constant Power Discharge(Watts/cell) at 25°C(77°F)

F.V/Time	10min	15min	30min	1H	2H	3H	4H	5H	8H	10H	20H
1.85V/cell	24.6	19.3	11.9	7.19	4.45	3.29	2.65	2.27	1.55	1.27	0.673
1.80V/cell	26.8	20.8	12.7	7.61	4.66	3.43	2.76	2.35	1.60	1.31	0.688
1.75V/cell	28.5	21.9	13.2	7.93	4.80	3.53	2.83	2.41	1.63	1.34	0.704
1.70V/cell	29.6	22.7	13.7	8.17	4.91	3.61	2.89	2.45	1.66	1.36	0.712
1.65V/cell	30.5	23.3	14.0	8.35	4.99	3.66	2.93	2.49	1.68	1.38	0.719
1.60V/cell	30.6	23.5	14.1	8.42	5.03	3.69	2.95	2.50	1.69	1.39	0.723

### Discharge Characteristics

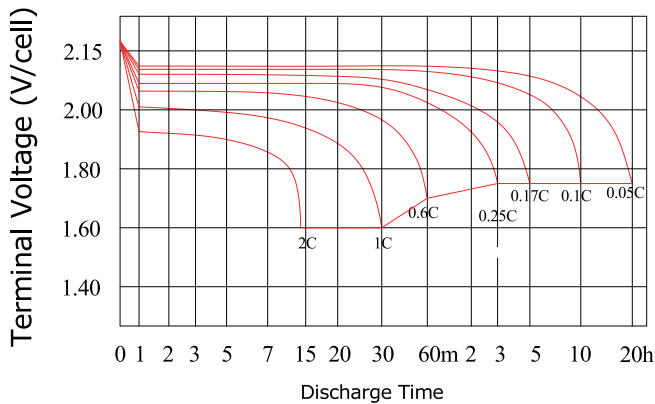

### Float Charge Characteristics

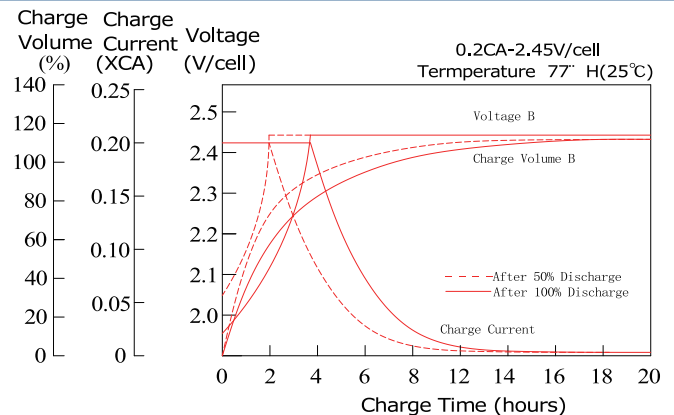

### Cycle Life in Relation to Depth of Discharge

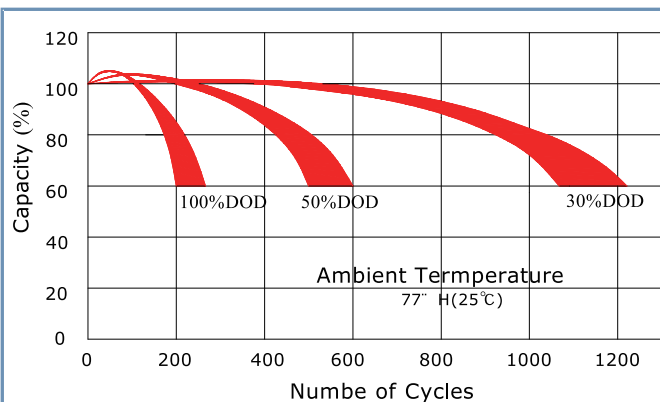

### Self Discharge Characteristics

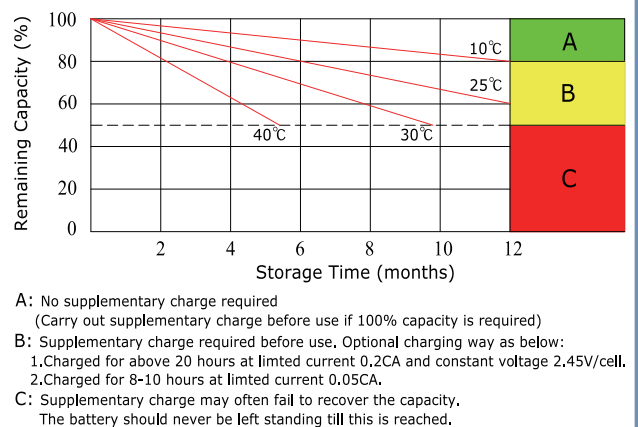

### Contact US